



BIG BUDDY

SPLICING OR ATTACHING NEW END FERRULE

Warning

Read manufacturer's instructions before using adhesive. In case of eye contact, flush with water and seek medical attention. If skin contact occurs, apply solvent (such as nail polish remover) to area and gently remove adhesive. Wash solvent off with water. Solvents should not be used in case of contact with eyes or open wounds.

Always wear safety goggles (ANSI Std. Z87.1) and gloves when working with adhesive and/or unprotected fiberglass rod.

1. Cut away damaged section(s) of fiberglass rodder with a fine-tooth hacksaw or sharp knife. Strip protective jacket back about 1-3/8". Do not cut into fiberglass core when stripping jacket. Do not crush fiberglass core.
2. Use emery cloth provided to roughen surface of fiberglass core end (Fig. 1).
3. Clean ends of fiberglass core with a cleaning solvent such as lacquer thinner or denatured alcohol before applying glue.
4. Allow cleaning solvent to evaporate.
5. Apply drop of adhesive to fiberglass core end (in case of a splice, do one end at a time as in Fig. 2A) and spread over core with toothpick or nail.
6. Twist splice ferrule as you insert rod (Fig. 2A and 2B). Clean off excess glue. Return unused materials to kit.
7. Allow adhesive to set three hours before using.

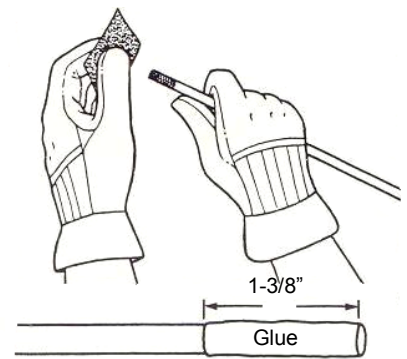

Fig. 1

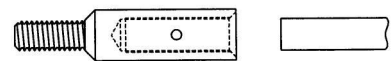

Fig. 2A End Ferrule Repair

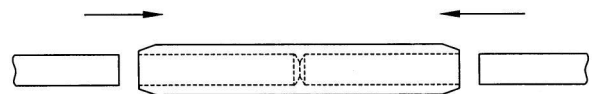

Fig. 2B Splice Repair



800.346.1956

www.jamesoncorp.com